

F:\CADD\MASTER STANDARD\dwg\JB-LAYOUTS.dwg 3/12/2015 3:27:29 PM EDT

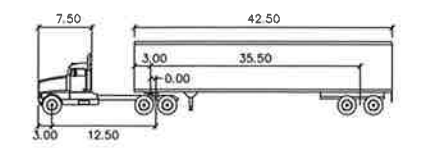
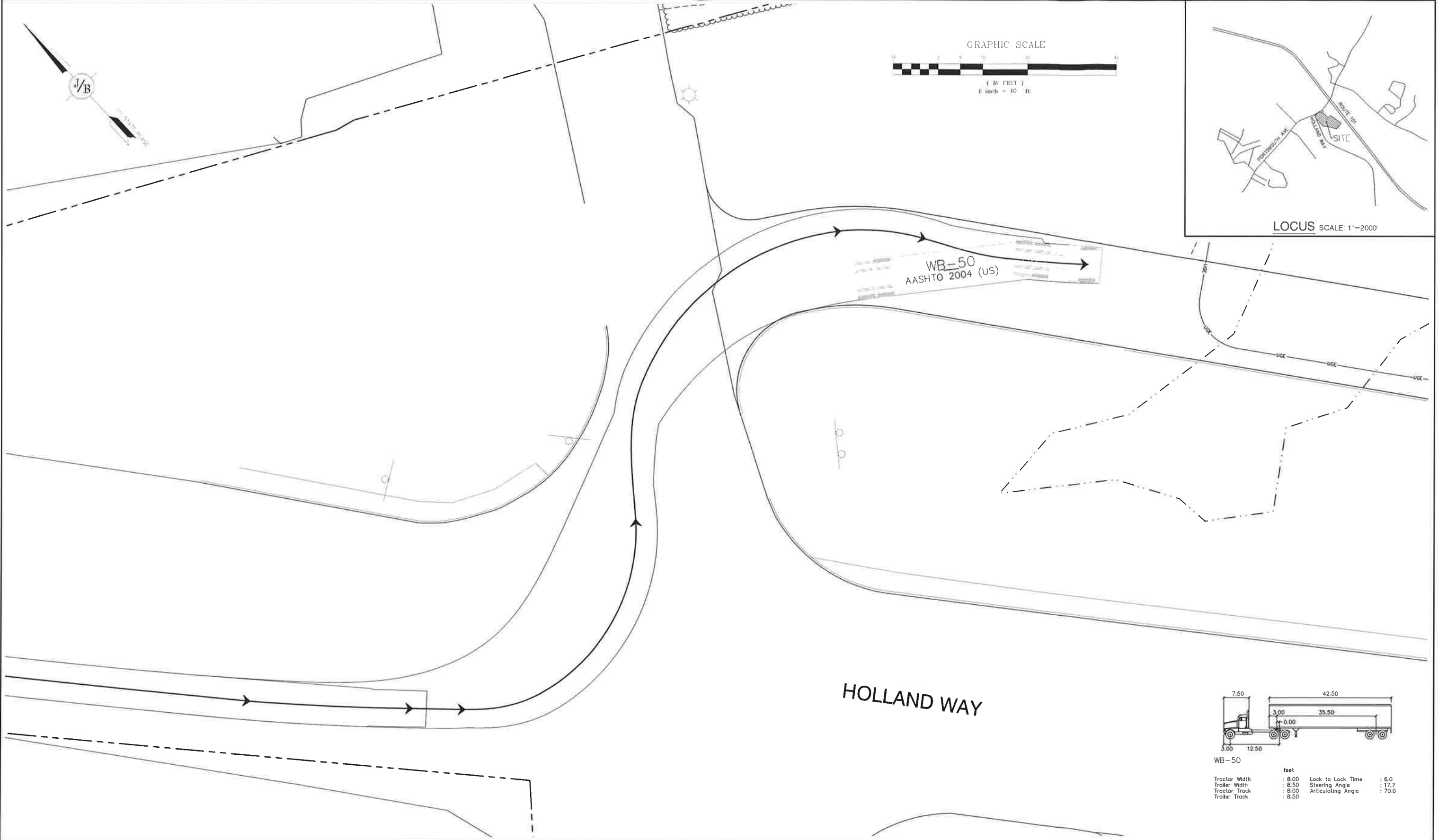

WB-50			
feet			
Tractor Width	: 8.00	Lock to Lock Time	: 6.0
Trailer Width	: 8.50	Steering Angle	: 17.7
Tractor Track	: 8.00	Articulating Angle	: 70.0
Trailer Track	: 8.50		

Design: EMP	Draft: GDR	Date: 12/01/2020
Checked: WGM	Scale: AS SHOWN	Project No.: 19198
Drawing Name: 19198-PLAN.dwg		
THIS PLAN SHALL NOT BE MODIFIED WITHOUT WRITTEN PERMISSION FROM JONES & BEACH ENGINEERS, INC. (JBE). ANY ALTERATIONS, AUTHORIZED OR OTHERWISE, SHALL BE AT THE USER'S SOLE RISK AND WITHOUT LIABILITY TO JBE.		

REV.	DATE	REVISION	BY
1	03/03/21	REVISED PER TRC COMMENTS	EMP
0	01/14/21	ISSUED FOR REVIEW	EMP

Designed and Produced in NH

J/B Jones & Beach Engineers, Inc.

85 Portsmouth Ave. Civil Engineering Services 603-772-4746
 PO Box 219 Stratham, NH 03885 FAX: 603-772-0227
 E-MAIL: JBE@JONESANDBEACH.COM

Plan Name:	TRUCK TURNING PLAN
Project:	STORAGE LOT 110 HOLLAND WAY, EXETER, NH
Owner of Record:	McFARLAND FORD SALES, INC 151 PORTSMOUTH AVE, EXETER, NH

DRAWING No.

T1

SHEET 1 OF 1
JBE PROJECT NO. 19198

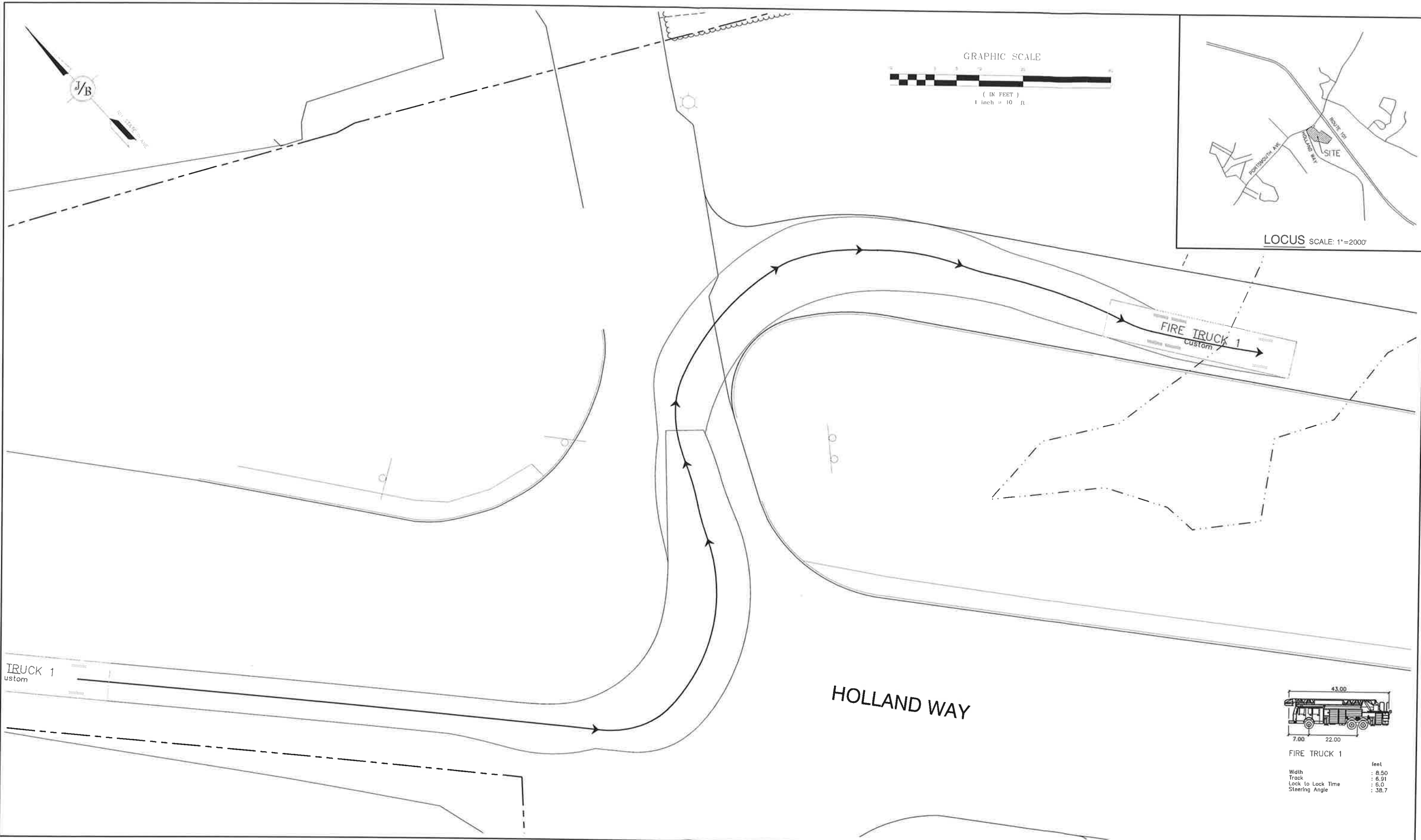

F:\CADD\MASTER STANDARD\dwg\JB-LAYOUTS.dwg 3/12/2015 3:27:29 PM EDT

TRUCK 1
custom

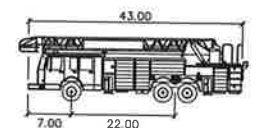

FIRE TRUCK 1
feet
Width : 8.50
Track : 6.91
Lock to Lock Time : 6.0
Steering Angle : 38.7

Design: EMP	Draft: GDR	Date: 12/01/2020
Checked: WGM	Scale: AS SHOWN	Project No.: 19198
Drawing Name: 19198-PLAN.dwg		
THIS PLAN SHALL NOT BE MODIFIED WITHOUT WRITTEN PERMISSION FROM JONES & BEACH ENGINEERS, INC. (JBE). ANY ALTERATIONS, AUTHORIZED OR OTHERWISE, SHALL BE AT THE USER'S SOLE RISK AND WITHOUT LIABILITY TO JBE.		

REV.	DATE	REVISION	BY
1	03/03/21	REVISED PER TRC COMMENTS	EMP
0	01/14/21	ISSUED FOR REVIEW	EMP

Designed and Produced in NH

J/B Jones & Beach Engineers, Inc.
Civil Engineering Services

85 Portsmouth Ave. PO Box 219 Stratham, NH 03885 603-772-4746 FAX: 603-772-0227 E-MAIL: JBE@JONESANDBEACH.COM

Plan Name:	TRUCK TURNING PLAN
Project:	STORAGE LOT 110 HOLLAND WAY, EXETER, NH
Owner of Record:	McFARLAND FORD SALES, INC 151 PORTSMOUTH AVE, EXETER, NH

DRAWING No.

T2

SHEET 1 OF 1
JBE PROJECT NO. 19198